

WD=WOODLAND CUL=CULTIVATED PA=PASTURE PAV=PAVED RES=RESIDENTIAL

DRAINAGE STRUCTURE DESIGN RECORD

STRUCTURE NO	STATION	STRUCTURE SIZE & TYPE	DRAINAGE AREA		LENGTH OF DRAINAGE AREA		SLOPE OF DRAINAGE AREA		ANTICIPATED LAND USE	SLOPE OF WATERSHED %, C <sub>1</sub>	RUNOFF CONCENTRATION T <sub>c</sub> MIN	INTENSITY OF DESIGN YEAR RAINFALL AND CHECK YEAR RAINFALL					DESIGN YEAR DISCHARGE AND CHECK YEAR DISCHARGE					E INLET ELEVATION	E OUTLET ELEVATION	AHW ALLOWABLE HEADWATER FEET	TW DESIGN TAILWATER FEET	STRUCTURE SLOPE FT/FT	OUTLET VELOCITY FT/SEC	TYPE OF HYDRAULIC OUTLET TREATMENT	REMARKS
			ACRE	LF	LF	%	%	INCHES PER HOUR					CUBIC FEET PER SEC																
								I <sub>5</sub>				I <sub>10</sub>	I <sub>25</sub>	I <sub>50</sub>	I <sub>100</sub>	Q <sub>5</sub>	Q <sub>10</sub>	Q <sub>25</sub>	Q <sub>50</sub>	Q <sub>100</sub>									
5	117+04.00	EXTEND EXIST 24" RCP	22.3	1450	4550	2.30	1.30	65% WD, 30% CUL, 5% PAV	1.54	0.15	56.28	2.30	2.65	3.06	3.47	3.79	7.86	9.04	11.49	14.21	16.15	1451.38	1449.19	1453.31	1449.53	0.031	9.86	RIPRAP	12" TYPE 1 PLAIN
8	153+05.10	EXTEND EXIST 24" RCP	42.9	2600	1700	1.20	0.50	95% CUL, 5% PAV	1.00	0.16	53.27	2.39	2.75	3.17	3.59	3.92	16.40	18.87	23.97	29.65	33.69	1498.52	1497.73	1501.92	1498.39	0.012	9.36	RIPRAP	12" TYPE 1 PLAIN
16	186+00.00	CONSTRUCT 24" RCP	27.4	2000	3300	0.30	0.40	95% CUL, 5% PAV	0.36	0.16	75.98	1.89	2.18	2.51	2.85	3.11	8.30	9.55	12.14	15.01	17.06	1507.59	1507.09	1509.57	1508.20	0.007	6.87	RIPRAP	12" TYPE 1 PLAIN
21	215+89.20	EXT 3'X2' RCB WITH 29"X45" RCPE	62.8	2100	2000	0.20	0.40	95% CUL, 5% PAV	0.30	0.16	68.71	2.02	2.33	2.69	3.05	3.32	20.35	23.42	29.74	36.80	41.82	1510.64	1510.54	1513.03	1511.87	0.002	6.38	RIPRAP	12" TYPE 1 PLAIN
23	231+42.10	EXTEND EXIST 2-5'X2' RCB	230.7	4500	5300	1.30	1.20	20% PA, 80% CUL	1.25	0.15	78.15	1.85	2.13	2.46	2.79	3.05	65.04	74.84	95.07	117.61	133.65	1516.00	1514.71	1518.05	1515.70	0.013	9.30	RIPRAP	12" TYPE 1 PLAIN
29	293+32.10	EXTEND EXIST 5'X4' RCB	76.1	2000	2600	1.00	1.20	19% PA, 80% CUL, 1% RES	1.11	0.15	53.94	2.37	2.72	3.15	3.57	3.89	27.13	31.22	39.65	49.05	55.74	1568.00	1567.32	1570.13	1568.01	0.012	8.95	RIPRAP	12" TYPE 1 PLAIN
32	310+93.80	EXTEND EXIST 18" CGSP	4.0	300	400	3.00	2.30	10% PA, 90% CUL	2.60	0.18	16.93	4.41	5.08	5.87	6.65	7.26	3.16	3.63	4.62	5.71	6.49	1601.98	1601.84	1603.29	1602.27	0.002	4.65		
34	325+16.20	EXT 3'X2' RCB WITH 29"X45" RCPE	27.7	1200	2800	1.60	1.00	10% PA, 90% CUL	1.18	0.18	47.44	2.56	2.95	3.41	3.86	4.22	12.60	14.49	18.41	22.78	25.88	1598.74	1594.59	1600.30	1595.57	0.058	13.56	RIPRAP	18" TYPE 1 PLAIN
38	362+59.10	EXTEND EXIST 18" RCP	12.7	1300	2200	0.80	2.80	20% PA, 80% CUL	2.06	0.18	43.27	2.71	3.12	3.60	4.09	4.46	6.04	6.95	8.82	10.92	12.41	1597.98	1596.41	1599.97	1596.87	0.025	9.67	RIPRAP	12" TYPE 1 PLAIN
42	368+91.00	EXTEND EXIST 5'X3' RCB	66.5	2100	2600	2.20	1.00	10% PA, 80% CUL, 10% RES	1.54	0.20	49.14	2.51	2.89	3.33	3.78	4.12	33.45	38.49	48.89	60.48	68.72	1589.35	1588.48	1591.76	1589.55	0.015	10.79	RIPRAP	18" TYPE 1 PLAIN
51	398+30.90	EXTEND EXIST 2-5'X2' RCB	89.2	2465	3200	4.00	2.30	20% PA, 75% CUL, 5% RES	3.04	0.21	45.74	2.62	3.02	3.48	3.95	4.31	48.81	56.16	71.34	88.26	100.29	1602.52	1600.85	1604.30	1601.58	0.027	12.27	RIPRAP	18" TYPE 1 PLAIN

RECEIVING WATERS  
FIVEMILE CREEK

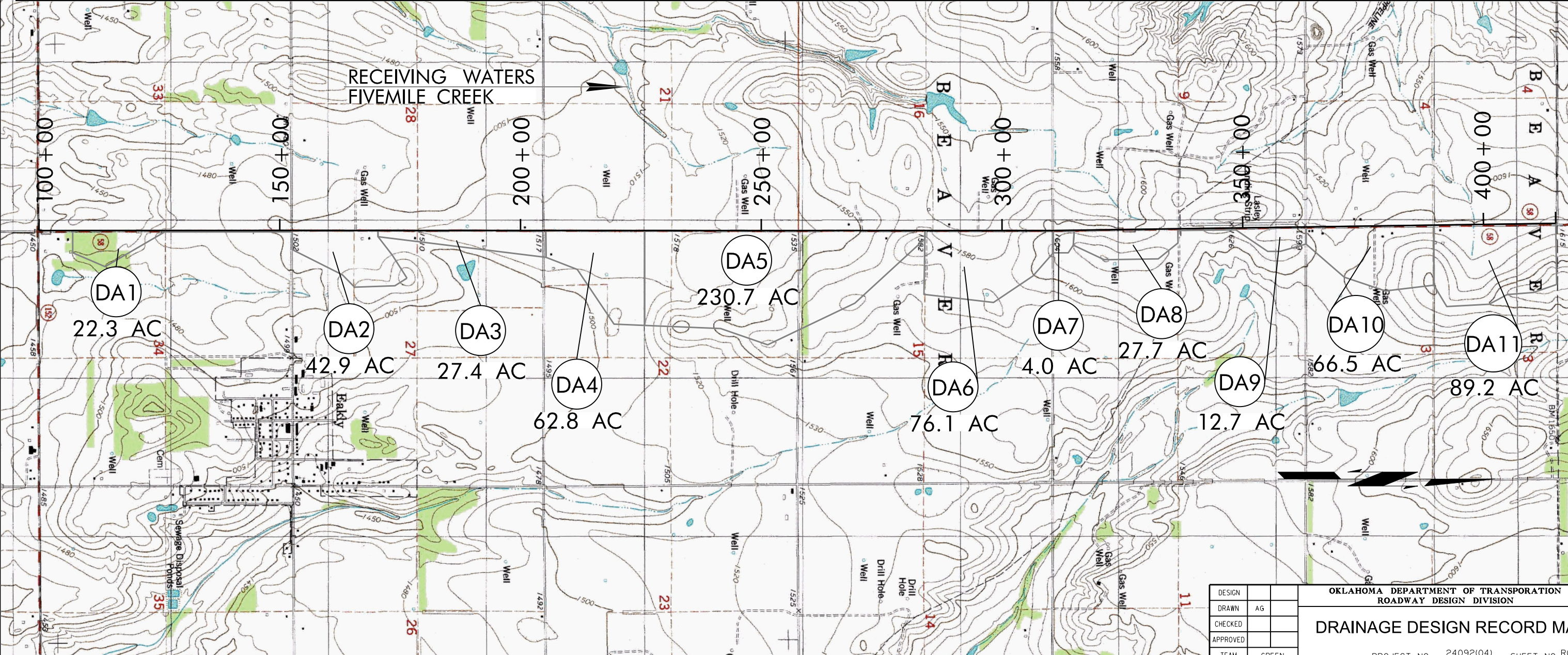

DESIGN		<p>OKLAHOMA DEPARTMENT OF TRANSPORTATION ROADWAY DESIGN DIVISION</p> <p><b>DRAINAGE DESIGN RECORD MAP</b></p> <p>PROJECT NO. 24092(04) SHEET NO. R004</p>
DRAWN	AG	
CHECKED		
APPROVED		
TEAM	GREEN	